

Aclaim 2™ HC401

PATIENT INSTRUCTIONS FOR USE

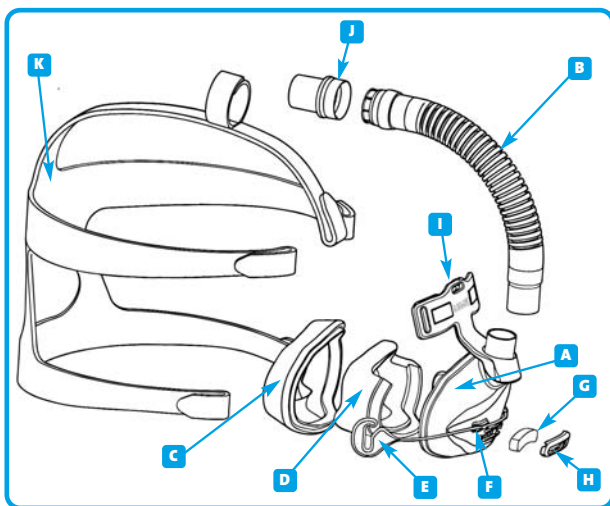

ASSEMBLING YOUR MASK

Your Aclaim 2™ mask is fully assembled and ready to use. However when you need to clean your mask, use the following instructions for reassembly.

Refer to the diagram left.

- Place the foam cushion (D) into the Mask Base (A).
- Starting at the apex of the mask, fit the Silicone Seal (C) over the Foam Cushion and onto the Mask Base, finishing at the bottom.
- Fit the small end of the Flexitube Assembly (B) onto the Mask Base.
- Push the Glider (E) into the Molded Slots (F) on the Mask Base.
- Fit the Diffuser (G) into the Diffuser Cap (H) and snap the assembly onto the Mask Base.
- Lay the Headgear (K) flat with the loop side down. Position the assembled mask over the headgear and attach the five straps to the corresponding slots in the Forehead Rest (I) and Glider. Finally, secure the Flexitube Assembly with the tab attached to the top strap.

CLEANING YOUR MASK

To ensure continuing safety and comfort from your Aclaim 2™ mask:

- BEFORE EACH USE:**
Inspect the mask for deterioration. Do not use if aged or badly discoloured.
- AFTER EACH USE:**
Disassemble the mask. Wash all parts except the Foam Cushion (D), Headgear and Diffuser (G) in warm soapy water, then rinse in fresh water before drying. Dishwashing detergent, shampoo or soap are suitable solutions for cleaning the mask. Wipe the Foam Cushion clean with a damp cloth or sponge and leave to dry. The Diffuser (F) should not be washed or rinsed. Simply replace it with a new Diffuser if it becomes noisy or deteriorates. It should last two to three months. Small dots may appear on the Diffuser - these do not affect its performance. The Aclaim 2™ nasal mask may be used with, or without the Diffuser and Diffuser Cap.
- EVERY 7 DAYS:**
Handwash the Headgear using mild household detergent. Before washing, join the tabs to prevent damage during washing.
If the mask weakens or cracks, seek a replacement immediately. Many people find CPAP therapy causes dryness of the nose and throat. Heated humidification can substantially reduce these symptoms. CONTACT YOUR SUPPLIER FOR DETAILS. The Aclaim 2™ mask and accessories are latex free.

FITTING YOUR MASK

- Holding your mask in one hand, spread the Headgear (K) with your free hand just enough to fit comfortably over your head.
 - Lightly hold the mask against your face covering the nose then slowly pull the Headgear over your head.
 - Attach the Headgear to the Glider™ Strap (E). Pull the lower straps as low as possible down back of neck. Gently tighten straps to remove slack. Connect to CPAP machine set at prescribed pressure.
 - Adjust the tension in each strap for comfort and to ensure there are no leaks. If you need to remove the mask, unhook the Headgear from the Glider Strap.
- If necessary, tighten the lower straps to eliminate any leaks (Avoid overtightening the straps).
 - Use the Silicone Seal that provides the best fit for you. Medium/Small and Large are both provided with your mask.
 - When you need to remove your mask, unhook the Headgear from the Glider™ Strap.

Whenever fitting your Aclaim 2™ nasal mask, make sure the CPAP machine is connected and running. This will ensure that exhaled CO₂ is being cleared through the Bias Flow Vent Holes.

OXYGEN/PRESSURE PORT CONNECTOR

If pressure readings and/or additional oxygen are required, an Oxygen/Pressure Port Connector is available. (Code 900HC452)

- Connect the large end of the connector (T) to the swivel (J) on the mask and the small end of the connector to the main breathing tube (R).
 - Open the Port Cap(s) (P) and place the pressure and/or oxygen tube (S) firmly over the Port(s) (Q).
- (The two ports are identical; either port may be used for oxygen or pressure measurement. Only remove the Port Cap from Ports that are being used.)

WARNINGS

- Use only with recommended CPAP or Bi-Level equipment. Consult your sleep technician for details.
- Operation pressure range is 3-25 cmH₂O.
- Do not use mask unless it is connected to a CPAP/Bi-Level machine that is running at a pressure of at least 3 cmH₂O.
- Do not use the mask if vomiting or feeling nauseous.
- Do not block the gas exhaust ports or use alternative Diffusers, other than those manufactured by Fisher & Paykel Healthcare. Before use, always ensure that gas is flowing out the exhaust ports or through the Diffuser (if it is being used).
- If re-using the Aclaim 2™ between different patients, refer to the Lab Reprocessing Instructions for the Aclaim 2™ nasal mask.
- Discontinue using the mask if there is an allergic reaction to any part of the mask. Consult your physician if this occurs.

CAUTION

- US Federal Law restricts this device to sale by, or on order of a physician.
- Operating temperature range is 40-140 °F (5-50 °C).
- Use mask for its' intended use only, as directed in this booklet.

BIAS FLOW INFORMATION

Nasal masks for CPAP and Bi-Level have bias flow holes to expel the air that you exhale from the mask. The Aclaim 2™ nasal mask has a unique Diffuser system that is designed to diffuse the air that is expelled from the mask. This reduces the draft. The Diffuser does not significantly change the amount of air flowing from the mask, therefore the mask can be used with or without the diffuser.

PRESSURE (cmH ₂ O)	3	5	7	9	11	13	15	17	19	21	23	25
FLOW (LPM)	15	19	23	26	28	31	33	35	37	39	41	43

RESISTANCE TO FLOW

Pressure drop through mask @ 50 LPM	0.1 cmH ₂ O
Pressure drop through mask @ 100 LPM	0.5 cmH ₂ O

O₂ TITRATOR AVAILABLE - 900HC452 - SEE SEPARATE INSTRUCTIONS FOR USE

RE-ORDER CODE : 900HC401

PATENT PENDING

